

PARID: 20073 09011

SAVANNAH DEVELOPMENT AND RENEWAL
AUTHORI

2205 MARTIN LUTHER KING BLVD

Most Current Owner

Current Owner	Co- Owner	Care Of	Mailing Address
SAVANNAH DEVELOPMENT AND RENEWAL AUTHORI	TY		131 HUTCHINSON ISLAND RD 4 SAVANNAH GA 31421

Digest Owner (January 1)

Owner	Co- Owner	Address 1	Address 2	City	State	Zip
SAVANNAH DEVELOPMENT AND RENEWAL AUTHORI	TY	131 HUTCHINSON ISLAND RD 4		SAVANNAH GA		31421

Parcel

Status	ACTIVE
Parcel ID	20073 09011
Category Code	RES - Residential
Bill #	3030275
Address	2205 MARTIN LUTHER KING BLVD
Unit # / Suite	
City	SAVANNAH
Zip Code	31415-
Neighborhood	08133.00 - H133 HOPKINS-FLORENC
Total Units	
Zoning	TC-1
Class	E1 - Exempt - Public Property
Appeal Status	

Legal Description

Legal Description	LOT C SUB OF LOTS 1 THRU 10 DALE WARD
Deed Book	1016
Deed Page	136

Permits

Permit #	Permit Date	Status	Type	Amount
99-6241D-1	10/12/1999	Expired	DM - DEMOLITION	\$313.00

Inspection

Inspection Date	Reviewer ID
12/19/2017	EPORTER
02/15/2017	FIRDAWSS

03/15/2013

PSMILLER

04/17/2007

WWROBERT

Appraised Values

Tax Year	Land	Building	Appraised Total	Reason
2020	9,000	17,400	26,400	
2019	9,000	17,400	26,400	
2018	9,000	14,600	23,600	
2017	4,300	14,600	18,900	
2016	4,300	16,100	20,400	
2015	4,300	16,100	20,400	
2014	8,500	16,200	24,700	
2013	8,500	16,600	25,100	
2012	8,500	21,600	30,100	
2011	8,500	19,100	27,600	

Sales

Sale Date	Sale Price	Sale Validity	Instrument	Book - Page	Grantor	Grantee
01/24/2017	0	U	WD	1016 - 136	MAYOR & ALDERMEN OF THE CITY OF SAVANNAH	SAVANNAH DEVELOPMENT AND RENEWAL AUTHORITY
01/12/2017	0	U		1705 - 0587	SAVANNAH DEVELOPMENT AND RENEWAL AUTHORITY	THE MAYOR AND ALDERMEN OF THE CITY OF SA
10/08/2010	0	U	WD	3640 - 4	HALL LEMUEL W & BRANKIE	MAYOR & ALDERMEN OF SAVANNAH
03/16/2005	0	U	QC	308B - 0543	WINSTON MARY ANN	HALL LEMUEL W & BRANKIE

Land

Line Number	1
Land Type	U - UNIT
Land Code	01 - SINGLE FAMILY RES
Square Feet	
Acres	
Influence Factor 1	
Influence Reason 1	
Influence Factor 2	
Influence Reason 2	

Residential Building

Card #	1
Actual Year Built	1920

Effective Year Built 1950
 Type 1 - Single Family Residence
 Style/Stories 2 - TWO STORY
 Percent Complete 100
 Quality 200
 Condition AV - AVERAGE
 Living Area 1,836
 Basement Area 0
 Finished Basement Area No
 Bedrooms 3
 Full / Half Baths 2 / 0

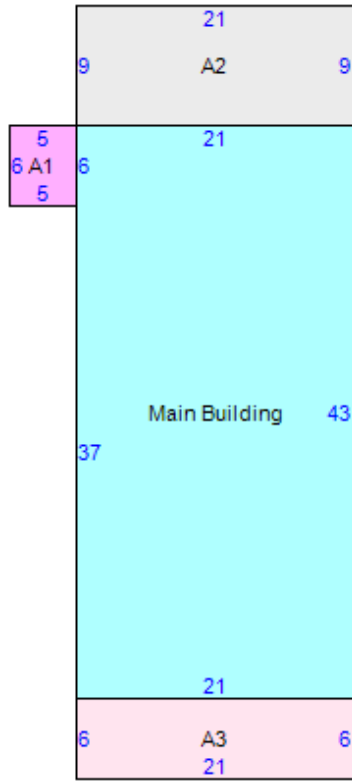

Item	Area
Main Building	903
A1 - 100:100- LIVING SPACE	30
A2 - 904:904-Slab Porch (SF) with Roof	189
A3 - 904:904-Slab Porch (SF) with Roof	126

